

WHEEL BRAKE CYLINDERS

For all our latest catalogue updates and company info: www.tvh.com

used for: **CROWN**

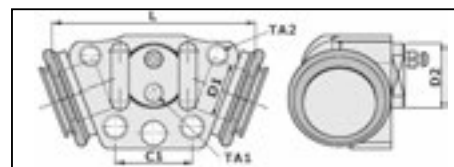

piston diameter (inch) D1	number of mounting holes AT-MG	dimension (mm) L	dimension (mm) D2	thread inlet TA1	dimension (mm) C1	thread mounting holes TA2	type of oil OLIE	reference
1	2	70	33	3/8 UNF X 24	32	1/4 UNC X 20	brake fluid	105TA4259
1	2	70	33	3/8 UNF X 24	32	1/4 UNC X 20	brake fluid	105TA4255
1	2	77	38	7/16 UNF X 20	42	5/16 UNC X 18	brake fluid	106TA6262
1	2	77	38	7/16 UNF X 20	42	5/16 UNC X 18	brake fluid	106TA6263
1 1/8	2	60	22	M10 X 1	30	M8 X 1,25	brake fluid	104TA4641



LH
REF [105TA4259](#)



RH
REF [105TA4255](#)



LH
REF [106TA6262](#)



RH
REF [106TA6263](#)



REF [104TA4641](#)